

1 2 3 4 5 6 7 8 9 10

A
B
C
D
E
F
G
H

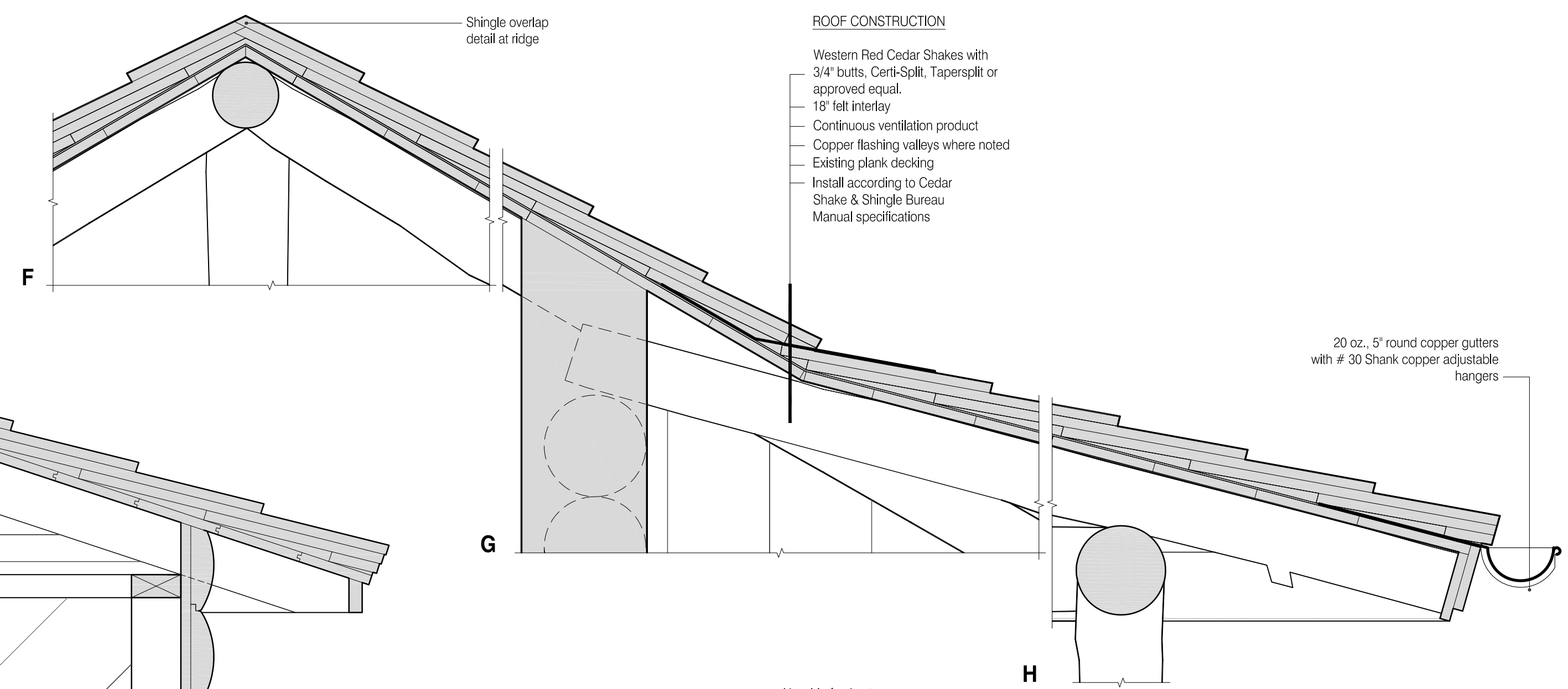
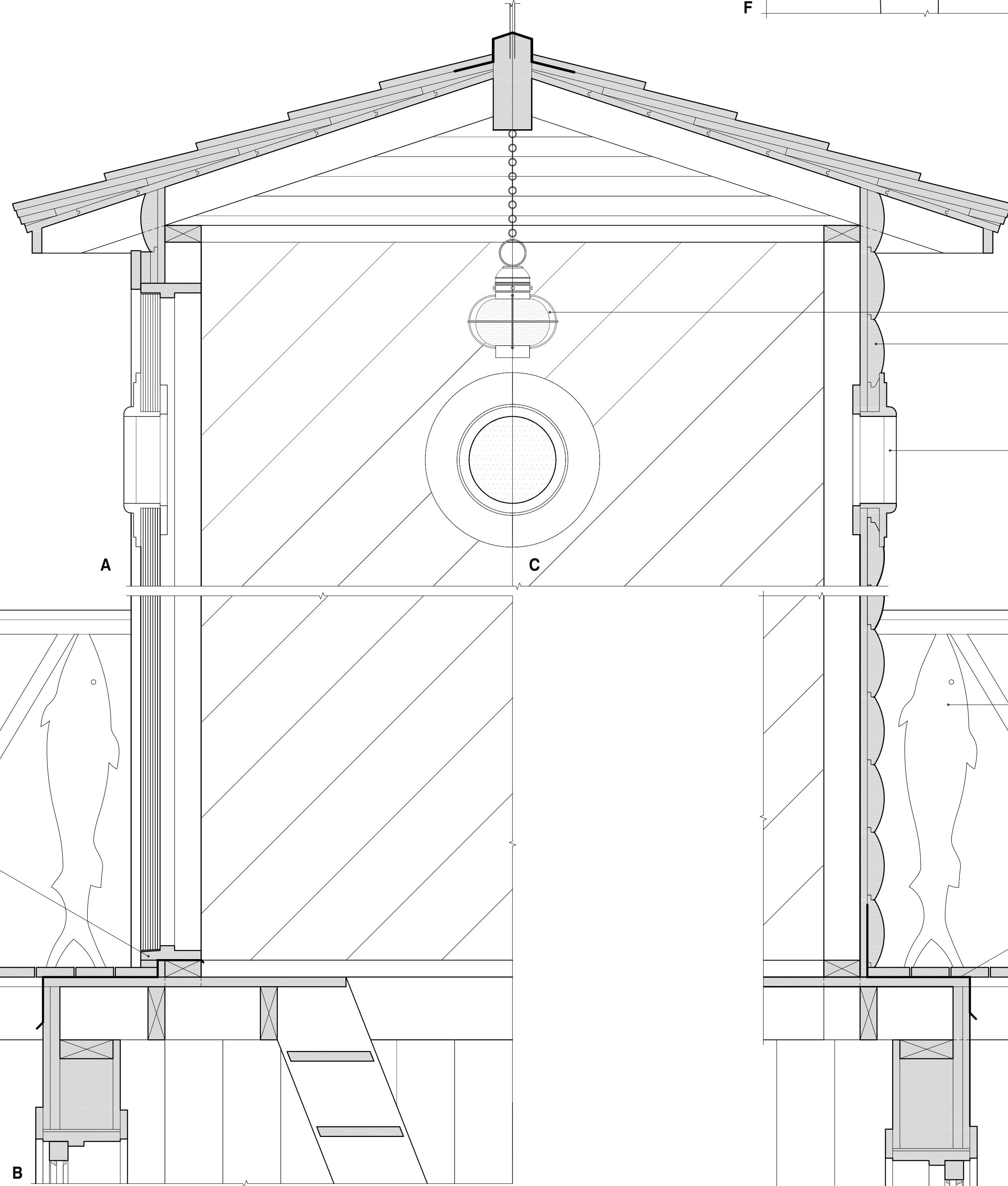
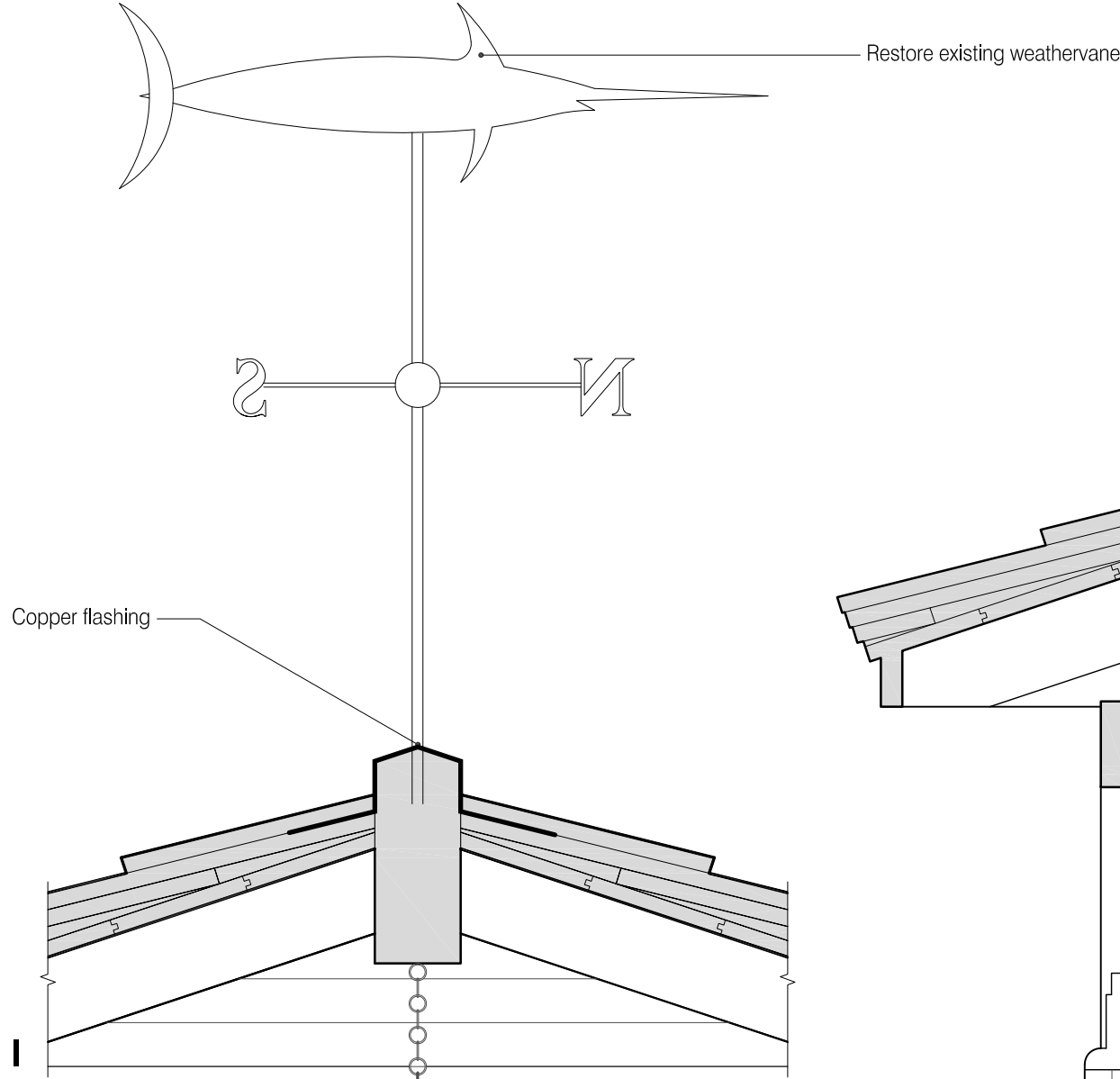

ROOF CONSTRUCTION

- Western Red Cedar Shakes with 3/4" butts, Clerk-Split, Tapersplit or approved equal.
- 18" felt interlay
- Continuous ventilation product
- Copper flashing valleys where noted
- Existing plank decking
- Install according to Cedar Shake & Shingle Bureau Manual specifications

New Cedar handrail
Copper flashing and new door sill

New Marine Lantern
Replace siding as necessary
Restore existing porthole window. Strip paint to brass

New balustrade - cut from plank cedar
New copper flashing
New 5/4" x 3 7/8" Cedar decking with 1/4" spacing, (2) S.S. screws at each joist
Flashing on top of cantilevered joist
New lattice window at existing location. Remove siding at area of window frame.

New cricket and copper flashing. See roof plans.

ANDRE TCHELISTCHEFF ARCHITECTS
560 Broadway Suite 609 New York NY 10012
Telephone 212 431 1503 Fax 212 431 1506

1. Issued for Board Review 02/07/12
2. Revised 02/23/12

Smith - Taylor Cabin
Taylor's Island
Town of Shelter Island, New York

Building Section
Details

Project # 11ST10
Scale: 11/2" = 1'-0"
7 December 2011

A3.1